

Architectural Series™

ARCHITECTURAL FINISH COMPONENT PAINTING AND INSTALLATION MANUAL



PAINTING THE FINISH COMPONENT

You can paint micro-perforated metal and cloth Architectural Series Finish Components before installing them. Use **ONLY** water-based latex paint on the Finish Component.

NOTE: THESE PAINTING INSTRUCTIONS ARE BASED ON THE USE OF PREMIUM-QUALITY PAINTS SUCH AS SHERWIN-WILLIAMS® AND BEHR® BRANDS. OTHER PAINT BRANDS MAY HAVE DIFFERENT AMOUNTS OF PIGMENT, WHICH MAY REQUIRE DIFFERENT DILUTION PROPORTIONS THAN ARE GIVEN IN THESE INSTRUCTIONS. WE RECOMMEND THAT YOU PERFORM A TEST BEFORE MAKING THE FINAL APPLICATION TO THE FINISH COMPONENT.

1. **For metal Finish Components only:** Before painting the Finish Component, carefully remove the scrim cloth from the underside of the Component. It is held in place with a light tacking glue. Remove the cloth carefully, since you will need to replace it when you're done painting the Finish Component.

NOTE: REMOVE ANY ADHESIVE RESIDUE FROM THE BACK OF THE FINISH COMPONENT BEFORE PAINTING.

2. Use a painter's tape designed for delicate surfaces (such as 3M Scotch Blue Painter's Tape For Delicate Surfaces, #2080) to mask the inside and outside surfaces of the Finish Component's rim.

- **For Finish Components with micro-trim:** Mask the inside and outside surfaces of the entire rim.
- **For trimless Finish Components:** Mask the inside and outside surfaces of the entire rim, but leave the top $\frac{1}{16}$ " (2mm) of the rim's outside surface exposed to the paint, since this will be visible when the Finish Component is installed on the speaker. (See Figure 1.)

3. Prime the grille with XIM Primer/Bonder (or similar) in a spray can. Carefully follow the directions on the can. (The primer helps prevent paint from clogging the Finish Component's micro perforations.)
4. Thin the paint to a ratio of 1:1 paint-to-water, and strain it through a standard mesh strainer to remove any lumps.
5. Use a small touch-up gun or capspray gun with a #3 tip for painting. Set the nozzle with a medium to wide fan, and set the pressure regulator to 60psi. Lightly spray the front of the Finish Component in three quick strokes from approximately 10 inches away. Paint at a slight angle to ensure that the paint covers the side walls of the perforations. Let the paint set for a minute, then turn the Finish Component 90° and repeat the painting process. (See Figure 2.)

Let the paint dry thoroughly, then turn the Finish Component 90° and repeat the painting process from the remaining two directions. This will ensure that all sides and edges of the Finish Component's perforations will be painted.

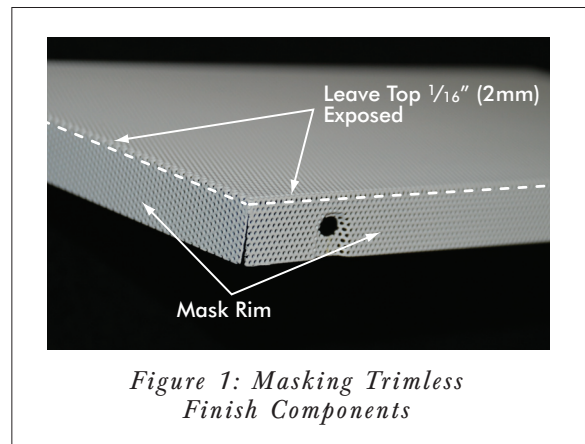

Figure 1: Masking Trimless Finish Components

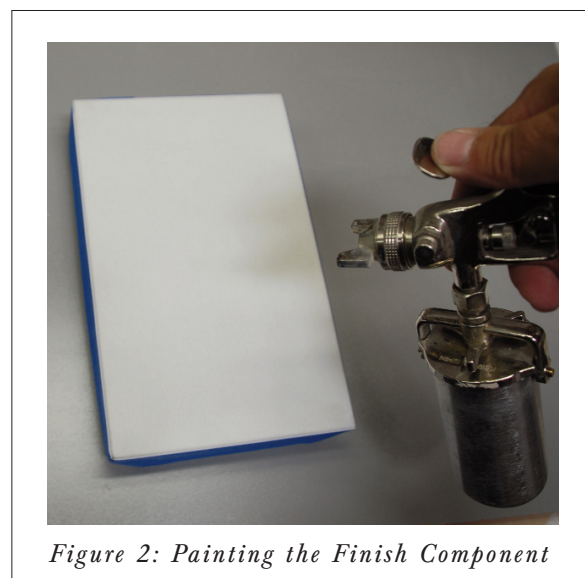

Figure 2: Painting the Finish Component

Architectural Series™



ARCHITECTURAL FINISH COMPONENT PAINTING AND INSTALLATION MANUAL

6a. For metal Finish Components: While the paint is still wet, inspect the Finish Component and make sure that none of the micro perforations are filled with paint. If any are, you should be able to use compressed air to blow the paint out of the perforation.

NOTE: IF YOU FIND ANY PERFORATIONS THAT ARE PLUGGED WITH PAINT AFTER THE PAINT HAS DRIED, USE A STRAIGHT PIN OR SEWING NEEDLE TO CAREFULLY REMOVE THE PAINT.

6b. For cloth Finish Components: While the paint is still wet, inspect the Finish Component and make sure that all of the areas of exposed grille cloth are properly covered.

7. Once the Finish Component is painted and dry, carefully remove the painter's tape from the rim. For metal Finish Components, replace the scrim cloth on the back side.

ATTACHING THE FINISH COMPONENT TO THE SPEAKER

IMPORTANT: Before attaching the Finish Component to the speaker, be sure your hands are clean!

1. The finish component inserts into the groove created by the Mud Dam on the bracket and the outer edge of the Architectural Series Speaker component (see *Figure 3*). It is secured in place by an engineered Precision-Fit ball bearing assembly.
2. Insert about half of the Finish Component rim into the groove on the speaker. Gently fit the remaining half of the rim by working around the speaker, fitting the rim into the groove as you go. (See *Figure 4*.)

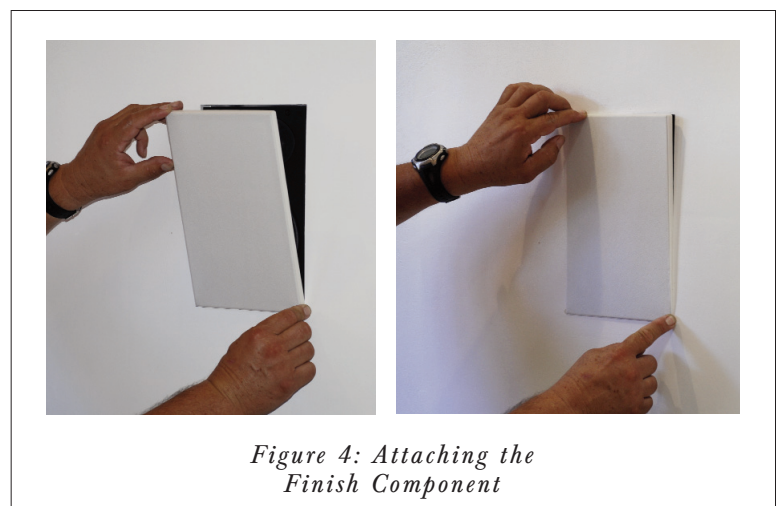
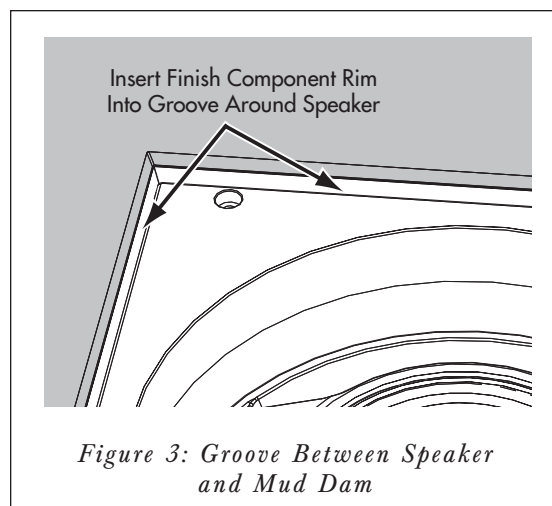

SONANCE®

©2009 Sonance. All rights reserved.

Sonance and Architectural Series are trademarks or registered trademarks of Dana Innovations.

Due to continuous product improvement, all specifications are subject to change without notice.

For the latest Sonance product specification information visit our website: www.sonance.com

SONANCE • 212 Avenida Fabricante • San Clemente, CA 92672-7531 • USA
800-582-7777 or 949-492-7777 • FAX: 949-361.5151 • Technical Support: 800-582-0772

www.sonance.com

33-4625

09.22.09